

V-Loc® Crashworthy Post & Mailbox Anchors



Standard
Concrete
Model
V-Loc®



New (wet) Concrete Installation User Guide

Existing (set) Concrete Installation on following page



Bottom
Plate &
Extended
Leg Angle



⚠ WARNING

Dial 811 BEFORE digging to have hazards pre-marked. Contact with utility lines could result in serious injury or death! TAPCO will not be liable for damage or injury resulting from improper installation. Always use Cut-proof Gloves, Safety Glasses, and OSHA-approved Protective Clothing and Devices while performing all procedures. Failure to do so could result in serious injury or death! Consider traffic control and lane closures to make installation less hazardous.



Know what's below.
Call before you dig.

V-Loc® Alignment (See illustrations at right)

Round Posts: Rounded nose points parallel to the road, AWAY FROM oncoming traffic (downstream).

Square Posts: Rounded nose points at a 45-degree angle TOWARD oncoming traffic, less on curves so that the traffic sign will face traffic.

U-channel Posts: Rounded nose points parallel to the road, TOWARD oncoming traffic (upstream).

New Concrete Installation (See next page for set concrete)

Install Concrete models with the curled fin corners facing downward. Extended leg angle and bottom plate models (shown at right) can reduce your setup time for new concrete installations.

Tape over the socket's opening(s) to prevent concrete spillage into the socket. With the subsurface leveled, place socket in the desired location at the proper depth so its top will be flush with the finished concrete surface, plumbed and aligned so the installed post will face the proper direction.

Fill around the socket with concrete, then re-check plumb on each inside face of the thick leg angle. Do not plumb to the thinner socket surfaces as they are tapered. If you're doing a large number of V-Loc installations you might weld a wedge to a post stub and use it to plumb, as shown at right (1). Trowel concrete (2), allowing it to fully cure per manufacturer's specs. Remove tape.

Post and Wedge Insertion

With the concrete fully cured, insert post 5 inches or more into socket, abutting it tight to the thick, 90° leg angle (3). Make sure the post, sign or mounted mailbox is (or will be) at the proper orientation angle and height according to national, state or local standards.

The wedge is tapered, so it MUST be inserted into the socket with the wedge's extractor side hole closest to the top (4). This produces the most secure mount, and allows the wedge puller tip to more easily hook the wedge hole if post removal becomes necessary. Insert the wedge at a slight angle as shown at right. Plumb the post. Drive the wedge fully into the socket, either flush with the top of the V-Loc, or up to as much as one inch below the top of the V-Loc. If you use an optional wedge insert (4), drive it into the wedge tapered side down.

If not done so already, the sign, mailbox or other device can now be mounted to the post.

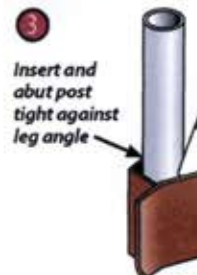
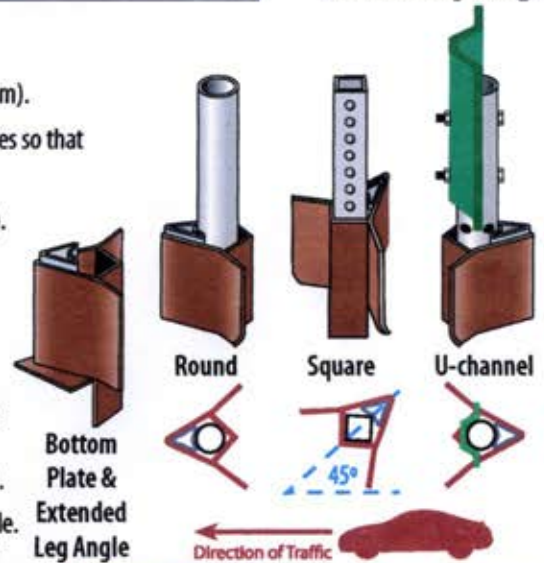

V-Loc® Crashworthy Post & Mailbox Anchors



Standard
Concrete
Model
V-Loc®



Existing (set) Concrete Installation User Guide

New (wet) Concrete Installation on previous page



Bottom
Plate &
Extended
Leg Angle



⚠ WARNING

Dial 811 BEFORE digging to have hazards pre-marked. Contact with utility lines could result in serious injury or death! TAPCO will not be liable for damage or injury resulting from improper installation. Always use Cut-proof Gloves, Safety Glasses, and OSHA-approved Protective Clothing and Devices while performing all procedures. Failure to do so could result in serious injury or death! Consider traffic control and lane closures to make installation less hazardous.



Know what's below.
Call before you dig.

V-Loc® Alignment (See illustrations at right)

Round Posts: Rounded nose points parallel to the road, AWAY FROM oncoming traffic (downstream).

Square Posts: Rounded nose points at a 45-degree angle TOWARD oncoming traffic, less on curves so that the traffic sign will face traffic.

U-channel Posts: Rounded nose points parallel to the road, TOWARD oncoming traffic (upstream).

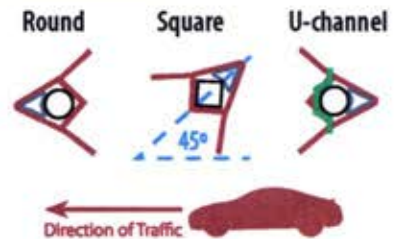

Set Concrete Installation (See previous page for wet concrete)

Cut or Bore a 6 or 7 inch hole through concrete (1). V-Loc Bottom Plate models can reduce setup time for concrete installations. Tape over the socket's top (and bottom if not using a bottom plate model) to prevent concrete spillage and upward migration into the socket. Install Concrete V-Loc models with either curled fin corners down, as shown at right, or bottom plate located at the bottom. Install socket to a depth whereby the top of the socket is level with the existing surface (2). Use a small level to plumb each inside face of the thick, 90° leg angle. Do not plumb to the thinner socket surfaces as they are tapered.

If you're doing a large number of V-Loc installations consider welding a spare wedge, with the extractor hole toward the top, flush with a post stub and use the stub to plumb your V-Loc® anchors (3). A quick-set mixture will suffice for existing concrete installations. Fill around the socket with concrete, then re-check the plumb on each inside face of the thick leg angle. Use a trowel (4) to smooth the surface and to force out any air pockets. Allow concrete to fully cure per manufacturer's specifications. Remove tape.

Post and Wedge Insertion

With the concrete fully cured, insert your post fully into socket (at least 5 inches), abutting it tightly to the thick, 90° leg angle (5). Make sure the post, sign or mounted mailbox is (or will be) at the proper orientation angle and height according to national, state or local standards.

The wedge is tapered, so it MUST be inserted into the socket with the wedge's extractor side hole closest to the top (6, 8). This produces the most secure mount, and allows the wedge puller tip to more easily hook the wedge hole if post removal becomes necessary. Insert the wedge at a slight angle as shown at right. Plumb the post. Drive the wedge fully into the socket, either flush with the top of the V-Loc (7), or up to as much as one inch below the top of the V-Loc. If you use an optional Wedge Insert (8), drive it into the wedge tapered side down. If not done so already, mount the sign, mailbox or other device to the post.

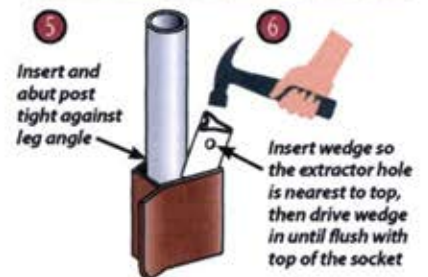

1-855-537-0200
www.forsite.us
customerservice@forsite.us
PO Box #51402
Jacksonville Beach, FL 32240