

# versatile™ 4C Mailbox, 4C11D-10

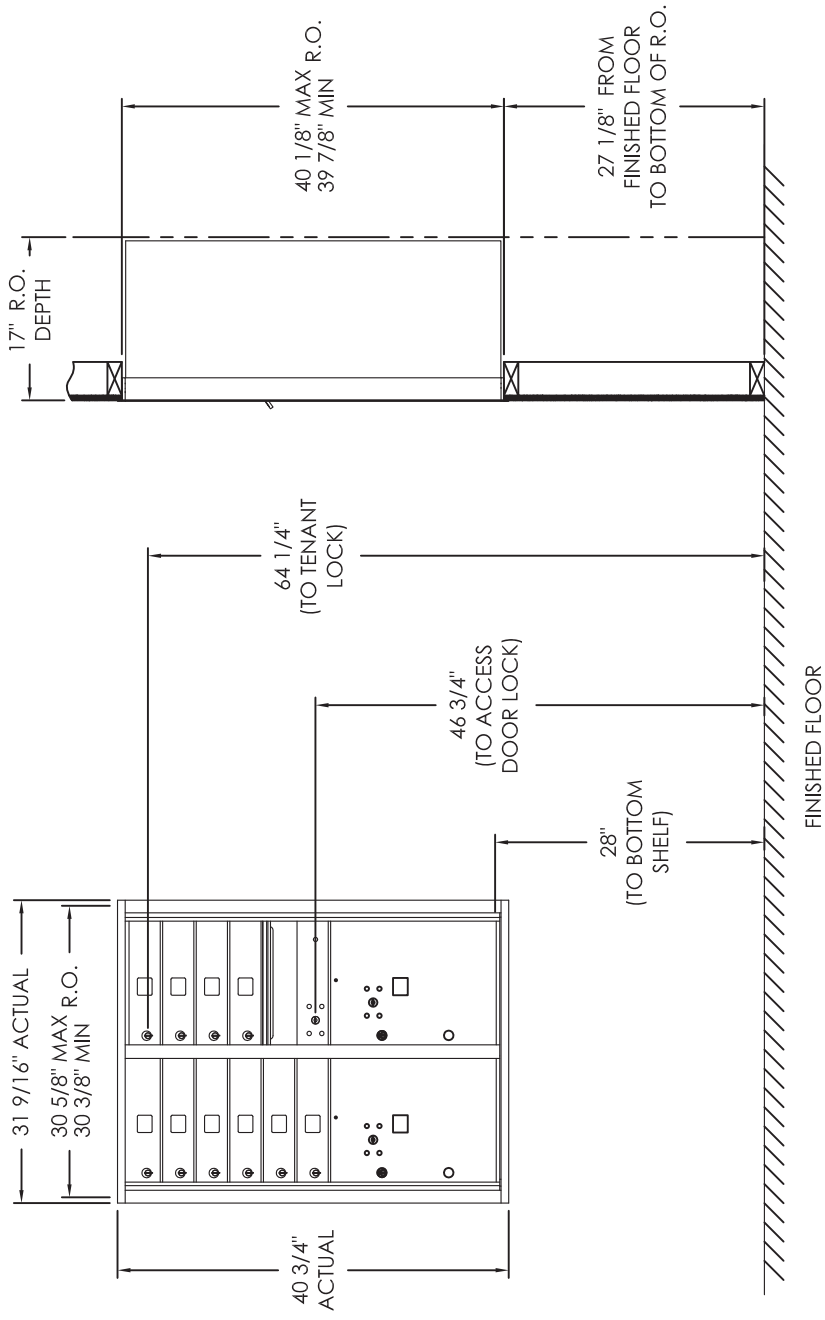

## COMPARTMENT CHART

DESCRIPTION	COMPARTMENT	COMPARTMENT SIZE	QTY.
MAILBOX	MB1	3" H x 12" W x 15" D	10
OUTGOING MAIL	OM2	6-1/2" H x 12" W x 15" D	1
PARCEL	PL5	17" H x 12" W x 15" D	2

## PRODUCT SERIES: VERSATILE™ 4C FRONT LOAD MAILBOX



**FORSITE**  
MAILBOXES, SIGNS & SITE AMENITIES  
Phone: 1-855-537-0200  
www.forsite.us  
customerservice@forsite.us  
P.O. Box 51402  
Jacksonville, FL 32240

Forsite is not responsible for checking local municipal codes. Please verify specifications with your municipality before placing an order. This document contains confidential and proprietary information that is the property of Forsite. It may not be shared, copied or used in whole or in part with third parties without the expressed written consent of Forsite.

**FABRICATION TO BEGIN AFTER DRAWING HAS BEEN APPROVED, SIGNED THEN FAXED OR EMAILED TO FORSITE.**  
Signature: \_\_\_\_\_ Date: \_\_\_\_\_

- Notes:
- This module meets the USPS STD-4C requirements for installation defined below when the mailbox is installed per the dimensions provided on this drawing.
    - At least one customer compartment shall be positioned less than 48" above finished floor (AFF).
    - No parcel locker (interior bottom shelf) shall be positioned less than 15" AFF.
    - No patron (tenant) lock shall be positioned more than 67" AFF.
    - No customer compartment (interior bottom shelf) shall be positioned less than 28" AFF.
    - The USPS Arrow lock shall be positioned 36"-48" AFF.
  - This 4C mailbox can also be used for private applications.